

Dry your hands effectively

1

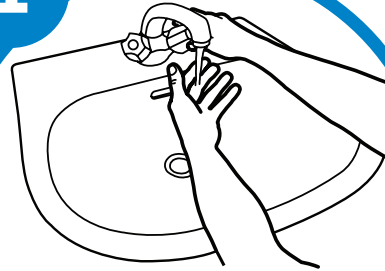

Wash your hands thoroughly with soap and water following 12 steps of hand washing. Turn the tap off with the towel

2

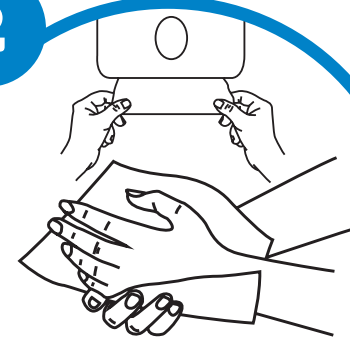

Take a single use paper towel from a dispenser & blot/pat dry your hands

3



Remember to dry spaces between your fingers thoroughly

4



Dispose of used paper towel in the foot operated bin, don't use your hands to lift or close the lid of the bin

Hand Drying - a key part of good hand hygiene